

Clamps

Pinch-On Single Ear Clamps

- band width: 1/4"
- band thickness: .030"
- sold in bag quantities only

Nominal Size	Range		Zinc Plated Steel		304 Stainless Steel		Pkg Qty
	closed	open	Part #	Price/E	Part #	Price/E	
3/8"	.350	.413	105	\$0.48	105R	\$0.53	100
7/16"	.382	.445	113	0.48	113R	0.54	100
15/32"	.409	.484	123	0.48	123R	0.55	100
1/2"	.449	.524	133	0.48	133R	0.55	100
35/64"	.469	.551	140	0.48	140R	0.56	100
9/16"	.496	.571	145	0.48	145R	0.57	100
5/8"	.543	.618	157	0.48	157R	0.58	100
11/16"	.595	.669	170	0.48	170R	0.59	100
23/32"	.618	.728	185	0.48	185R	0.60	100
3/4"	.669	.780	198	0.49	198R	0.62	100
13/16"	.717	.827	210	0.50	210R	0.65	100
7/8"	.780	.890	226	0.51	226R	0.66	100
15/16"	.839	.949	241	0.51	241R	0.67	100
1"	.898	1.008	256	0.52	256R	0.69	100
1-1/16"	.945	1.067	271	0.53	271R	0.71	100
1-1/8"	1.004	1.126	286	0.55	286R	0.72	100
1-3/16"	1.063	1.185	301	0.56	301R	0.74	100
1-5/16"	1.181	1.303	331	0.58	331R	0.77	100
1-3/8"	1.240	1.362	346	0.60	346R	0.79	100
1-15/32"	1.358	1.480	376	0.63	376R	0.82	100
1-9/16"	1.437	1.559	396	0.67	396R	0.86	100
1-5/8"	1.492	1.614	410	0.68	410R	0.87	100
1-11/16"	1.551	1.673	425	0.70	425R	0.89	100
1-23/32"	1.610	1.732	440	0.71	440R	0.91	100
1-3/4"	1.669	1.791	455	0.72	455R	0.92	100
1-13/16"	1.728	1.850	470	0.75	470R	0.94	100
1-7/8"	1.787	1.909	485	0.77	485R	0.96	100
1-15/16"	1.847	1.969	500	0.79	500R	0.97	100
2"	1.906	2.028	515	0.80	515R	0.99	100

**Pinch-On Double Ear Clamps**

- When ordering double ear clamps, select nominal clamp size nearest to, but always larger than, the OD of material to be clamped after insert has been fitted.

Nominal Size	Range		Zinc Plated Steel		304 Stainless Steel		Pkg Qty
	closed	open	Part #	Price/E	Part #	Price/E	
3/16"	.134	.197	0305	\$0.81	0305R	\$1.05	100
1/4"	.197	.276	0507	0.85	0507R	1.10	100
5/16"	.276	.354	0709	0.85	0709R	1.15	100
3/8"	.319	.433	0811	0.86	0811R	1.16	100
1/2"	.425	.512	1113	0.87	1113R	1.24	100
9/16"	.492	.591	1315	1.04	1315R	1.43	100
19/32"	.551	.669	1517	1.05	1517R	1.58	100
5/8"	.591	.709	1518	1.05	1518R	1.68	100
3/4"	.638	.787	1720	1.14	1720R	1.88	100
13/16"	.709	.866	1922	2.07	1922R	1.93	100
7/8"	.748	.906	2023	1.30	2023R	2.08	100
15/16"	.827	.984	2225	2.42	2225R	2.17	100
1"	.886	1.063	2327	1.55	2327R	2.32	100
1-1/8"	1.035	1.221	2731	1.70	2731R	2.62	100
1-7/16"	1.260	1.457	3437	1.89	3437R	3.06	100
1-1/2"	1.378	1.575	3740	3.29	3740R	3.20	100



Stepless® Ear Clamps

Technical Information:

Stepless® ear clamps hold against pressure and vibration or material shrinkage due to temperature changes or aging. A built-in spring action permits the clamp to breathe without loosening. When installing Stepless® ear type clamps over an object, please note that each ear must be crimped closed to obtain a proper seal.

- once installed and clamped, any tampering is easily visible
- *Clamps are not reusable*; they should not be pried open, doing so renders the clamps nonfunctional.
- When ordering Stepless® ear clamps, select the nominal size nearest to, but always larger than, the outside diameter of the material to be clamped. The outside diameter should be determined with connection fully assembled.
- sold in quantities of 100 per bag

SAFETY
ALERT

Features:

- 304 stainless steel
- ensured clamping seal
- for low durometer and/or thin-walled hose/tubing
- for silicon, vinyl, polyurethane or other high-tech materials
- Smooth inner band prevents damage to the hose while the tongue-in-groove design provides a 360° seal.
- no steps or gaps inside the clamp
- Install clamps using 1098 or 1099 clamp tools below.

Nominal Size	Range (inches)		304 Stainless Steel	
	closed	open	Part #	Price/E
9/32"	.228	.275	0983	\$0.99
3/8"	.307	.374	0986	0.99
7/16"	.378	.445	0989	0.99
1/2"	.425	.524	0993	0.99
35/64"	.453	.551	0997	1.00
9/16"	.472	.571	0999	1.01
5/8"	.520	.618	1005	1.02
11/16"	.571	.669	1009	1.03
3/4"	.654	.779	1021	1.18
13/16"	.701	.827	1029	1.21



Clamps

Clamp Service Kit

Plastic kit box contains zinc plated 2-ear clamps:

- 15 of part #0709
- 15 of part #0811
- 15 of part #1113
- 15 of part #1315
- 15 of part #1518
- 12 of part #1720
- 12 of part #2023
- 12 of part #2225
- 12 of part #2327
- 1 pair of standard jaw pincers, part # 1098

Part #	Price/E
SK1098	\$184.70



Clamp Construction Kit

Plastic construction clamp kit box contains the following:

- 50 of part #2225 (zinc plated, 2-ear clamps)
- 40 of part #2731 (zinc plated, 2-ear clamps)
- 6 hose menders (1/2", plastic)
- 1 pair of long handle pincers

Part #	Price/E
18500116	\$351.00



Oetiker® Clamp Tools for Pinch-On Clamps



straight jaw

Part #	Price/E
9901	\$104.95



standard jaw

Part #	Price/E
1098	\$61.10



side jaw

Part #	Price/E
1099	\$74.55

Clamps

Dixon Worm Gear Clamps

- four-piece construction
- clamp meets SAEJ1508 which supercedes Mil Spec WW-C-440B
- screw design: 5/16" slotted hex head
- maximum recommended torque 50 in. lbs.
- *all clamps sold 10 per box*

Style HS material:

- band and housing: SAE 201/301 series stainless
- screw: SAE 1018 case-hardened, hex-free chrome zinc-plated steel

Style HSS material:

- band and housing: SAE 300 series stainless
- screw: SAE 300 series stainless



style HS



style HSS

Band Width	Hose OD		style HS		Case Qty	style HSS		Case Qty
	from	to	Part #	Price/E		Part #	Price/E	
1/2"	28/64"	50/64"	HS6	\$1.45	200	HSS6	\$1.95	200
	32/64"	58/64"	HS8	1.45	200	HSS8	1.95	200
	36/64"	1-4/64"	HS10	1.45	500	HSS10	1.95	500
	44/64"	1-16/64"	HS12	1.50	500	HSS12	1.95	500
	52/64"	1-32/64"	HS16	1.50	500	HSS16	1.95	500
	52/64"	1-48/64"	HS20	1.50	500	HSS20	2.00	500
	1-4/64"	2"	HS24	1.50	500	HSS24	2.00	500
	1-20/64"	2-16/64"	HS28	1.55	500	HSS28	2.00	500
	1-36/64"	2-32/64"	HS32	1.55	500	HSS32	2.00	500
	1-52/64"	2-48/64"	HS36	1.60	500	HSS36	2.10	500
	2-4/64"	3"	HS40	1.95	200	HSS40	2.35	200
	2-20/64"	3-16/64"	HS44	2.15	200	HSS44	2.70	200
	2-36/64"	3-32/64"	HS48	2.15	200	HSS48	2.70	200
	2-52/64"	3-48/64"	HS52	2.30	200	HSS52	2.85	200
	3-4/64"	4"	HS56	2.30	200	HSS56	2.85	200
	3-20/64"	4-16/64"	HS60	2.40	200	HSS60	2.90	200
9/16"	3-36/64"	4-32/64"	HS64	2.40	200	HSS64	2.90	200
	1-56/64"	5"	HS72	2.60	100	HSS72	3.20	100
	2-32/64"	5-32/64"	HS80	3.00	100	HSS80	3.30	100
	3-8/64"	6"	HS88	3.10	100	HSS88	3.65	100
	3-40/64"	6-32/64"	HS96	3.15	100	HSS96	3.75	100
	4-8/64"	7"	HS104	3.20	100	HSS104	3.25	100
	5-40/64"	8-32/64"	HS128	4.75	100	HSS128	5.10	100
	7-8/64"	10"	HS152	5.10	100	HSS152	5.65	100
	9-24/64"	12-16/64"	HS188	5.60	100	HSS188	6.15	100
	10-8/64"	13"	HS200	5.65	100	HSS200	6.40	100
	10-56/64"	13-48/64"	HS212	5.70	100	HSS212	6.80	100
	11-40/64"	14-32/64"	HS224	6.35	100	HSS224	7.20	100
	12-24/64"	15-16/64"	HS236	6.90	100	HSS236	7.95	100
	13-8/64"	16"	HS248	7.20	100	HSS248	8.90	100
17-8/64"	20"	HS312	8.80	100	HSS312	10.10	100	

Miniature Worm Gear Clamps

- screw design: 1/4" slotted hex head
- maximum recommended torque 15 in. lbs.
- *all clamps sold 10 per box*
- meets SAE J1508

Style MH material:

- band and housing: SAE 201/301 series stainless
- screw: SAE 1018 case-hardened, hex-free chrome zinc-plated steel

Style MAH material:

- band and housing: SAE 300 series stainless
- screw: SAE 300 series stainless



style MH



style MAH

Band Width	Hose OD		style MH		Case Qty	style MAH		Case Qty
	from	to	Part #	Price/E		Part #	Price/E	
5/16"	14/64"	40/64"	MH4	\$1.10	500	MAH4	\$1.40	500
	28/64"	50/64"	MH6	1.10	500	MAH6	1.40	500
	32/64"	58/64"	MH8	1.30	200	MAH8	1.60	200
	36/64"	1-4/64"	MH10	1.30	200	MAH10	1.60	200
	44/64"	1-16/64"	MH12	1.35	200	MAH12	1.70	200
	60/64"	1-32/64"	MH16	1.35	200	MAH16	1.70	200
	1-12/64"	1-48/64"	MH20	1.40	200	MAH20	1.70	200

SAFETY ALERT Torque ratings correspond to the torque rating of the screw of the clamp and are not an indication of the working pressure of any hose assembly installed with this clamp.

Clamps

Quick Release Clamps

- maximum recommended torque 30 in. lbs.
 - screw design: 5/16" slotted hex head
 - Parts showing package quantities are sold in package quantities only.
- Style LS material: Style LSS material:
- band and housing: 301 series stainless • band and housing: 301 series stainless
 - screw: plated hardened carbon steel • screw: SAE 410 series stainless

Band Width	Hose OD		style LS			style LSS			Pkg Qty
	from	to	Part #	Price/E	Pkg Qty	Part #	Price/E	Pkg Qty	
1/2"	1-32/64"	3-32/64"	LS48	\$2.75	10	LSS48	\$4.35	10	
	1"	4"	LS56	2.90	10	---	---	--	
	2"	5"	LS72	3.40	10	LSS72	4.30	10	
	2-4/64"	6"	LS88	3.95	10	LSS88	5.30	10	
	3-32/64"	6-36/64"	LS96	3.90	--	---	---	--	
	1-48/64"	7"	LS104	4.90	--	LSS104	6.00	10	
	1-48/64"	8-36/64"	LS128	4.65	--	LSS128	5.90	--	
	2"	10"	LS152	7.15	--	---	---	--	
	2-4/64"	12-20/64"	LS188	5.80	--	LSS188	6.95	--	
	10-12/64"	14"	---	---	--	LSS216	7.55	--	
	10-48/64"	16"	---	---	--	LSS248	8.55	--	

Torque ratings correspond to the torque rating of the screw of the clamp and are not an indication of the working pressure of any hose assembly installed with this clamp. **SAFETY ALERT**



style LS



style LSS

Aero-Seal® Liner Clamps

- The integral extension of the band as a liner (no rivets or welds) protects soft surface hose (silicone and others) from damage caused by extrusion or shearing through the band slots.
- screw design: 5/16 hex slotted hex head

- Style DL material: Style DLS material:
- band, saddle, housing: stainless steel • band, saddle, housing: stainless steel
 - screw: plated carbon steel • screw: 410 stainless steel

Band Width	Hose OD		style DL		style DLS		Pkg Qty
	from	to	Part #	Price/E	Part #	Price/E	
1/2"	7/16"	25/32"	DL9206	\$2.95	DLS9406	\$3.55	10
	1/2"	29/32"	DL9208	2.95	DLS9408	3.55	10
	9/16"	1-1/16"	DL9210	2.95	DLS9410	3.55	10
	11/16"	1-1/4"	DL9212	3.00	DLS9412	3.65	10
	13/16"	1-1/2"	DL9216	3.00	DLS9416	3.65	10
	13/16"	1-3/4"	DL9220	3.05	DLS9420	3.65	10
	1-1/16"	2"	DL9224	3.05	DLS9424	3.65	10
	1-5/16"	2-1/4"	DL9228	3.10	DLS9428	3.70	10
	1-9/16"	2-1/2"	DL9232	3.10	DLS9432	3.70	10
	1-13/16"	2-3/4"	DL9236	3.20	DLS9436	3.85	10
	2-1/16"	3"	DL9240	3.90	DLS9440	4.65	10
	2-5/16"	3-1/4"	DL9244	4.20	DLS9444	4.85	10
	2-9/16"	3-1/2"	DL9248	4.20	DLS9448	5.00	10



style DLS

Thumb Screw Clamps

- worm gear style clamp, no tools required
- screw cap removable to make clamp tamper resistant
- plated carbon steel screw with a yellow thermoplastic screw cap, removable and reusable
- band and housing are stainless steel

Band Width	Hose OD		Stainless Steel		Pkg Qty
	from	to	Part #	Price/E	
5/16"	1/4"	5/8"	MH4Y	\$6.10	10
5/16"	5/16"	7/8"	MH6Y	6.10	10
1/2"	1/2"	1-1/4"	HS12Y	7.10	10
1/2"	3/4"	1-3/4"	HS20Y	7.60	10
1/2"	1-1/4"	2-1/4"	HS28Y	8.05	10



Thumb Screw Clamp

New for 2012

Clamps

Crowder Supply Co., Inc. • 8495 Roslyn St., Commerce City, CO 80022 • Toll Free: 888-883-5144 • www.CrowderSupply.com

Clamps

Aero-Seal® Clamps

- four-piece construction
- band slots designed for strength and smooth action
- saddle interlocks into embossed band to form a true concentric circle
- slotted hex head screw design
- heat treated screws have buttress thread type
- safety collar or thumb screw available
- maximum recommended torque 50 in. lbs.
- sold only in boxes of 10

Style 100 material:

- band and housing: 300 series stainless
- screw: plated carbon steel

Style 200 material:

- band and housing: 300 series stainless
- screw: 410 series stainless

Style 300 material:

- band and housing: 302 series stainless
- screw: high corrosion resistant 305 stainless



style 100

Band Width	Hose OD		style 100		style 200		style 300		Pkg Qty
	from	to	Part #	Price/E	Part #	Price/E	Part #	Price/E	
9/16"	28/64"	50/64"	10006	\$1.85	20006	\$2.30	30006	\$2.65	10
	32/64"	58/64"	10008	1.85	20008	2.30	30008	2.65	10
	36/64"	1-4/64"	10010	1.85	20010	2.30	30010	2.65	10
	44/64"	1-16/64"	10012	1.95	20012	2.35	30012	2.70	10
	52/64"	1-32/64"	10016	1.95	20016	2.35	30016	2.70	10
	52/64"	1-48/64"	10020	1.95	20020	2.40	30020	2.75	10
	1-4/64"	2"	10024	1.95	20024	2.40	30024	2.75	10
	1-20/64"	2-16/64"	10028	2.00	20028	2.45	30028	2.80	10
	1-36/64"	2-32/64"	10032	2.00	20032	2.45	30032	2.80	10
	1-52/64"	2-48/64"	10036	2.05	20036	2.50	30036	2.85	10
	2-4/64"	3"	10040	2.50	20040	3.10	30040	3.50	10
	2-20/64"	3-16/64"	10044	2.70	20044	3.40	30044	3.80	10
	2-36/64"	3-32/64"	10048	2.70	20048	3.35	30048	3.80	10
	2-52/64"	3-48/64"	10052	2.90	20052	3.60	30052	4.05	10
	3-4/64"	4"	10056	2.90	20056	3.60	30056	4.05	10
	3-20/64"	4-16/64"	10060	3.10	20060	3.90	30060	4.35	10

SAFETY ALERT Torque ratings correspond to the torque rating of the screw of the clamp and are not an indication of the working pressure of any hose assembly installed with this clamp.

HTM Hi Torque Clamps

- withstands more than three times the SAE torque requirements for worm-driven clamps
- eight screw threads are engaged in the band simultaneously for incredible torquing drive (over 150 in. lbs.), sealing pressure and vibration resistance
- slotted hex head screw design

Material:

- band and housing: 300 series half hard stainless
- screw: 410 stainless steel screw



style HTM

Band Width	Hose OD		Stainless Steel		Opt Qty
	from	to	Part #	Price/E	
5/8"	1-16/64"	2-8/64"	HTM200	\$4.75	10
	1-48/64"	2-40/64"	HTM250	4.85	10
	2-16/64"	3-8/64"	HTM300	5.00	10
	2-48/64"	3-40/64"	HTM350	5.10	10
	3-16/64"	4-8/64"	HTM400	5.25	10
	3-48/64"	4-40/64"	HTM450	5.40	10
	4-16/64"	5-8/64"	HTM500	5.60	10
	4-48/64"	5-40/64"	HTM550	5.95	10
	5-16/64"	6-8/64"	HTM600	6.10	10
	5-48/64"	6-40/64"	HTM650	6.20	10
	6-16/64"	7-8/64"	HTM700	6.40	10
	6-48/64"	7-40/64"	HTM750	6.90	10
	7-16/64"	8-8/64"	HTM800	7.05	10
	7-48/64"	8-40/64"	HTM850	7.20	10
8-16/64"	9-8/64"	HTM900	7.40	10	

extended range clamps

Band Width	Hose OD		Stainless Steel	
	from	to	Part #	Price/E
5/8"	1-16/64"	2-40/64"	HP2	\$4.80
	2-8/64"	4-8/64"	HP3	5.30
	4"	6-8/64"	HP4	6.15
	6-8/64"	9-8/64"	HP5	7.40

Clamps

Constant Torque Clamps

A patented Belleville spring mechanism permits the Constant-Torque clamp to automatically increase or decrease its own diameter due to changes in operational or environmental temperatures.

- 3/8" hex, carbon steel screw, 5/8" wide 304 stainless steel band

Band Width	Hose OD		Part #	Price/E	Hose OD		Part #	Price/E
	from	to			from	to		
5/8"	1"	1-3/4"	CT175L	\$18.25	5 1/4"	6-1/8"	CT600L	\$20.50
	1 1/4"	2-1/8"	CT200L	18.25	5 3/4"	6-5/8"	CT650L	20.60
	1 3/4"	2-5/8"	CT250L	18.35	6 1/4"	7-1/8"	CT700L	21.00
	2 1/4"	3-1/8"	CT300L	18.70	6 3/4"	7-5/8"	CT750L	21.80
	2 3/4"	3-5/8"	CT350L	18.85	7 1/4"	8-1/8"	CT800L	22.10
	3 1/4"	4-1/8"	CT400L	19.10	7 3/4"	8-5/8"	CT850L	22.50
	3 3/4"	4-5/8"	CT450L	19.30	8 1/4"	9-1/8"	CT900L	22.75
	4 1/4"	5-1/8"	CT500L	19.65	8 3/4"	9-5/8"	CT950L	23.00
	4 3/4"	5-5/8"	CT550L	20.25				



Make-A-Clamp Kits

This is a maintenance clamp system in a box. By simply cutting off a piece of banding from a continuous roll, you can make any size stainless steel worm-driven clamp from 3" diameter and up. It is a must for anyone likely to encounter requirements for varying sized large clamps.

- reusable
- band width: 1/2"
- band thickness: .023"
- screw design: 5/16" slotted hex head
- band and housing material: 302 stainless, screw material: 410 stainless

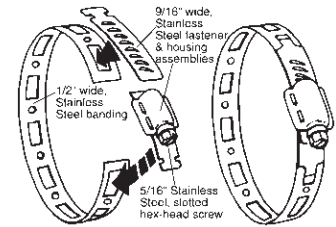

Contents	Stainless Steel	
	Part #	Price/E
mini kit: 8 1/2' band, 3 adjustable fasteners, 1 band splice	4000	\$25.75
kit with 100' band, 25 adjustable fasteners, 10 band splices	4001	201.00
kit with 50' band, 10 adjustable fasteners, 5 band splices	4002	105.10
box with 10 adjustable fasteners : priced per box	4004	42.25
box with 100' band, 10 band splices	4005	102.00
box with 50' band, 5 band splices	4006	54.60
6" demonstrator kit with clamps	4007	16.50
box with 10 band splices : priced per box	4008	24.25



Dixon Racks for Worm Gear Clamps

- top load metal rack made of nickel plated steel rods with enameled steel sign
- sign identifies each clamp size and diameter range
- rack with clamps contains 9 clamp sizes with diameter ranges from 7/32" - 2-3/4"

Clamps included are:

- 30 of part# MH4
- 30 of part# MH6
- 20 of part# HS10
- 20 of part# HS12
- 20 of part# HS20
- 20 of part# HS24
- 20 of part# HS28
- 20 of part# HS32
- 20 of part# HS36

Description	Part #	Price/E
with 200 clamps	CRWC	\$350.20
without clamps	CR	89.65



CRWC



CR

Band Clamps - F series Center Punch Clamps

- for use with center punch tools F1, F38, F40 and F100 located on page 351, other manufacturer's punch style tools may also be used
- on stainless clamps, bands are 300 series stainless steel, buckles are 302 series stainless steel

style F (pre-formed)

Band Width	ID	Band THK	Stainless Steel		Pkg Qty	Band THK	Galvanized Steel		Pkg Qty
			Part #	Price/E			Part #	Price/E	
3/8"	13/16"	.020	FS3	\$1.55	100	.025	F3	\$0.95	100
	1-3/8"	.020	FS311	1.75	100	.025	F311	1.00	100
5/8"	1"	.022	FS4	2.05	100	.025	F4	1.05	100
	1-1/4"	.022	FS5	2.20	100	.025	F5	1.10	100
	1-1/2"	.022	FS6	2.35	100	.031	F6	1.20	100
	1-3/4"	.022	FS7	2.55	100	.031	F7	1.30	100
	2"	.022	FS8	2.70	100	.031	F8	1.35	100
	2-1/4"	.022	FS9	2.85	100	.031	F9	1.40	100
	2-1/2"	.022	FS10	3.10	50	.031	F10	1.65	50
	2-3/4"	.022	FS11	3.25	50	.031	F11	1.70	50
	3"	.022	FS12	3.45	50	.031	F12	1.80	50
	3-1/2"	.022	FS14	3.80	50	.031	F14	1.95	50
	4"	.022	FS16	4.25	25	.031	F16	2.20	25
	4-1/2"	.022	FS18	4.60	25	.031	F18	2.40	25
	5"	.022	FS20	4.95	25	.031	F20	2.45	25
	6"	.022	FS24	5.65	25	.031	F24	2.90	25
7"	.022	FS28	6.40	25	.031	F28	3.40	25	
8"	.022	FS32	7.10	25	.031	F32	3.70	25	



style F

style FO (open end)

Band Width	ID	Band THK	Stainless Steel		Pkg Qty	Band THK	Galvanized Steel		Pkg Qty
			Part #	Price/E			Part #	Price/E	
3/8"	13/16"	.020	FOS3	\$3.70	100	.025	FO3	\$3.30	100
	1-3/8"	.020	FOS311	3.90	100	.025	FO311	3.40	100
	2"	.020	FOS316	4.10	100	.025	FO316	3.45	100
	3-1/8"	.020	FOS325	4.40	100	.025	FO325	3.60	100
5/8"	2"	.022	FOS8	3.85	100	.025	FO8	2.20	100
	2-1/2"	.022	FOS10	4.25	50	.025	FO10	2.30	50
	3"	.022	FOS12	4.65	50	.031	FO12	2.45	50
	3-1/2"	.022	FOS14	5.05	50	.031	FO14	2.60	50
	4"	.022	FOS16	5.40	50	.031	FO16	2.70	50
	4-1/2"	.022	FOS18	5.75	50	.031	FO18	2.90	50
	5"	.022	FOS20	6.20	25	.031	FO20	3.10	25
	6"	.022	FOS24	6.95	25	.031	FO24	3.30	25
	7"	.022	FOS28	8.10	25	.031	FO28	3.50	25
	8"	.022	FOS32	9.10	25	.031	FO32	3.80	25
	9"	.022	---	---	25	.031	FO36	4.35	25
	10"	.022	---	---	25	.031	FO40	4.60	25
	12"	.022	---	---	25	.031	FO48	5.55	25
	14"	.022	---	---	10	.031	FO56	6.75	10



style FO

Band Clamps - K series

The Universal Preformed Clamp

- can be center punched or rolled over, for use with the center punch or roll over tools located on page 351
- on stainless clamps, bands are 300 series stainless steel, buckles are 302 series stainless steel
- Fast-Lok™ tools: F1, F40, F100 (page 351)
- Super Strap Tools: 51960 screw action with 51970 adapter (page 352)
- Bandit®: S100 air tool with S180 Jr. head, C-001 hand tool with J001 Jr. adapter, S350 air tool with S260 Jr. head, T-240 for 3/8" only or T-250 for 3/8" and 5/8", S-38 for 3/8" and 5/8", J-102 Pok-It™ for 3/8" only.
- Punch-Lok® tools: P-1000 for 3/8" and 5/8", P-3000 for 3/8" only, P-38 for 3/8" and 5/8"
- sold in package quantities only

style K (pre-formed)

Band Width	ID	Band THK	Stainless Steel			Band THK	Galvanized Steel		
			Part #	Price/E	Pkg Qty		Part #	Price/E	Pkg Qty
3/8"	13/16"	.025	KS3	\$1.55	100	.025	K3	\$1.00	100
	1-3/8"	.025	KS311	1.75	100	.025	K311	1.05	100
5/8"	1"	.031	KS4	2.65	100	.030	K4	1.40	100
	1-1/4"	.031	KS5	2.70	100	.030	K5	1.45	100
	1-1/2"	.031	KS6	2.90	100	.030	K6	1.55	100
	1-3/4"	.031	KS7	3.10	100	.030	K7	1.60	100
	2"	.031	KS8	3.30	100	.030	K8	1.65	100
	2-1/4"	.031	KS9	3.55	100	.030	K9	1.70	100
	2-1/2"	.031	KS10	3.80	50	.030	K10	1.75	50
	2-3/4"	.031	KS11	4.15	50	.030	K11	1.95	50
	3"	.031	KS12	4.35	50	.030	K12	2.00	50
	3-1/2"	.031	KS14	4.80	50	.030	K14	2.15	50
	4"	.031	KS16	5.35	25	.030	K16	2.40	25
	4-1/2"	.031	KS18	5.75	25	.030	K18	2.50	25
	5"	.031	KS20	6.20	25	.030	K20	2.70	25
	6"	.031	KS24	7.05	25	.030	K24	3.10	25
	7"	.031	KS28	8.05	25	.030	K28	3.60	25
8"	.031	KS32	8.95	25	.030	K32	3.80	25	



Clamps

- 3/4" width K Clamp must be applied with F175 hand tool located on page 351

3/4" width style K (pre-formed)

Band Width	ID	Band THK	Stainless Steel		Pkg Qty
			Part #	Price/E	
3/4"	2"	.030	KS87501	\$4.60	100
	2-1/4"	.030	KS97501	4.65	100
	2-1/2"	.030	KS107501	4.85	50
	2-3/4"	.030	KS117501	5.05	50
	3"	.030	KS127501	5.30	50
	3-1/2"	.030	KS147501	5.80	50
	4"	.030	KS167501	6.40	25
	4-1/2"	.030	KS187501	7.05	25
	5"	.030	KS207501	7.50	25
	6"	.030	KS247501	8.70	25
	7"	.030	KS287501	10.00	25
8"	.030	KS327501	11.00	25	

Dixon Smooth ID Clamps

As industrial hose made of stiffer, thinner thermoplastics replaces soft, spongy thick-walled rubber, a new generation of hose clamps has been developed to prevent leak problems. The smooth ID clamp is manufactured in a wide variety of widths, sizes and materials that provide a uniform, gap-free inside diameter, and strong holding power. For use with roll over type clamp tools and most common band clamp tools such as the 51960 and 51970 band tools on page 352.



Band Width	ID	Band THK	201 Stainless Steel		Pkg Qty	Galvanized Steel		Pkg Qty
			Part #	Price/E		Part #	Price/E	
3/8"	13/16"	.025	JS201	\$2.45	100	JS301	\$1.20	100
	1"	.025	JS243	2.80	100	JS343	1.15	100
	1-3/8"	.025	JS202	2.70	100	JS302	1.25	100
	2"	.025	JS245	3.10	100	---	---	---
1/2"	1"	.030	JS203	3.40	100	JS303	1.45	100
	1-1/4"	.030	JS204	3.70	100	JS304	1.55	100
	2-3/4"	.030	JS230	5.60	100	JS330 ¹	2.30	100
5/8"	1-1/2"	.030	JS205	4.50	100	JS305	1.70	100
	1-3/4"	.030	JS206	4.95	100	JS306	1.90	100
	2"	.030	JS207	5.45	100	JS307	2.15	100
	2-1/4"	.030	JS208	5.75	100	JS308	2.20	100
	2-1/2"	.030	JS209	6.15	100	JS309	2.35	100
	3-1/2"	.030	JS210	7.30	50	JS310	2.85	50
3/4"	3"	.030	JS211	7.95	50	JS311	3.00	50
	3-1/2"	.030	JS212	8.45	50	JS312	3.20	50
	4"	.030	JS213	9.65	25	JS313	3.70	25
	4-1/2"	.030	JS214	10.40	25	JS314	3.90	25
	5"	.030	JS215	11.20	25	JS315	4.30	25
	6"	.030	JS216	12.90	25	JS316 ¹	4.95	25
	7"	.030	JS218	15.50	25	---	---	---

¹ stock quantities only

Dixon Smooth ID Center Punch Clamps

Center punch clamps are double wrapped and locked with the conical punch of the F100 tool (page 351). Recommended for use in applications where conditions are highly corrosive.

- unique dimple design offers excellent sealing strength while maintaining radial compression
- heavy buckle provides optimal holding power
- ideal for thin wall hose
- low profile clamp
- clamp can be applied with the F100 hand tool located on page 351
- band width: 5/8"
- band thickness: .025"



Band Width	ID	Band THK	201 Stainless Steel		Pkg Qty
			Part #	Price/E	
5/8"	1"	.025	HBC4S	\$2.20	100
	1 1/4"	.025	HBC5S	2.40	100
	1 1/2"	.025	HBC6S	2.50	100
	1 3/4"	.025	HBC7S	2.70	100
	2"	.025	HBC8S	2.90	100
	2 1/4"	.025	HBC9S	3.05	100
	2 1/2"	.025	HBC10S	3.30	50
	2 3/4"	.025	HBC11S	3.45	50
	3"	.025	HBC12S	3.60	50
	3 1/2"	.025	HBC14S	4.00	50
	4"	.025	HBC16S	4.55	25
	4 1/2"	.025	HBC18S	4.80	25
	5"	.025	HBC20S	5.15	25
	6"	.025	HBC24S	5.90	25
	7"	.025	HBC28S	6.65	25
	8"	.025	HBC32S	7.40	25

Band Clamp Hand Tools

Description	Part #	Price/E
Portable locking hand tool used to apply punch type 3/8" and 5/8" band clamps. For use with F series only.	F38	\$85.00



Description	Part #	Price/E
Intermediate hand tool for 3/8" and 5/8" band clamps.	F40	\$148.00



Description	Part #	Price/E
Hand tool for application of 5/8" band clamps. Imported tool.	F1	\$205.60

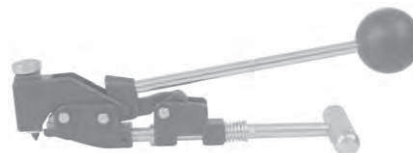

Description	Part #	Price/E
Hand tool for application of 3/8" and 5/8" band clamps.	F100	\$346.50



Description	Part #	Price/E
Hand tool for application of 3/4" K clamps only.	F175	\$869.00



Description	Part #	Price/E
3/8" clamp adapter for F100 tool only.	F229	\$20.75



Band Clamp Tool Accessories

Description	Part #	Price/E
Mallet for punching band clamps	F225	\$70.50



Description	Part #	Price/E
Clamp cutter	F550	\$136.50



Clamps

Band and Buckle

- to be used with C2 or 51960 band clamp tools on bottom of page
- sold in box quantities only



strapping



buckles

strapping

Band Width	Band Thickness	Length	201 Stainless Steel		Galvanized Steel	
			Part #	Price/bx	Part #	Price/bx
3/8"	.025	100'	SS375	\$99.00	SG375	\$50.15
1/2"	.031	100'	SS500	136.70	SG500	63.00
5/8"	.031	100'	SS625	185.40	SG625	76.00
3/4"	.031	100'	SS750	223.10	SG750	90.00

buckles

Buckle Width	201 Stainless Steel			Galvanized Steel		
	Part #	Price/E	Pkg Qty	Part #	Price/E	Pkg Qty
3/8"	CS375	\$0.70	100	CG375	\$0.32	100
1/2"	CS500	0.95	100	CG500	0.48	100
5/8"	CS625	1.30	100	CG625	0.53	100
3/4"	CS750	1.65	100	CG750	0.75	50

Set Screw Buckles

- Used in applications when a temporary clamp is desired or space limitations do not allow for tool roll-over, set screw locks band after tensioning.
- sold in box quantities only



Buckle Width	201 Stainless Steel		Pkg Qty
	Part #	Price/E	
3/8"	SSB375	\$5.60	50
1/2"	SSB500	4.00	25
3/4"	SSB750¹	5.10	25

¹ 3/4" buckle may be used with 5/8" band

**New
for 2012**

Stainless Steel Banding

- resistant to moisture
- built-in handle
- full view of available band
- easy to dispense and recoil



Band Width	Band Thickness	Length	Package Type	201 Stainless Steel	
				Part #	Price/tote
1/2"	.030	100'	plastic blue tote	ST204B	\$266.90
5/8"	.030	100'	plastic green tote	ST205G	317.45
3/4"	.030	100'	plastic red tote	ST206R	371.15

Band Clamp Tools



Description	Part #	Price/E
Clamping tool for band and buckles	C2	\$455.00



Description	Part #	Price/E
Clamping tool for band and buckles	51960	\$155.90



Description	Part #	Price/E
adapter for 51960 tool to install preformed clamps	51970	\$139.00

Strap-Grip Saddles and Male Stems

Strap-Grip saddles are designed to provide greater resistance to end pull than conventional band clamps alone. The male fittings shown below are designed for use with Strap-Grip saddles. Cam and Groove fittings are available on page 60. Saddles are designed for use with 3/4" or 5/8" wide bands. A band clamp should first be applied to OD to seal the hose in sizes 3" and over. Then Strap-Grip saddles should be banded on top of initial clamps to anchor the fitting in the hose.

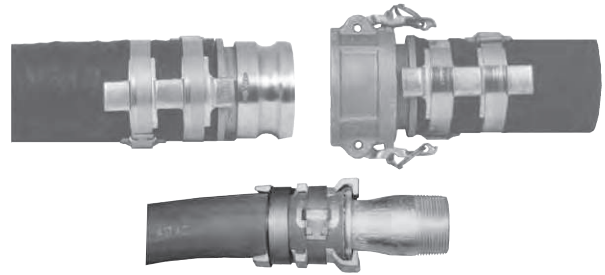

Size	Hose OD		Plated Iron	
	from	to	Part #	Price/pair
1½"	1-13/16"	2-1/8"	SGS150	\$14.00
2"	2-5/8"	3"	SGS200	16.50
3"	3-1/2"	3-7/8"	SGS300	21.00
4"	4-9/16"	5-1/8"	SGS400	23.70
6"	6-1/2"	7-1/16"	SGS600	42.00
8"	8-5/8"	9-3/8"	SGS800 ¹	45.00



saddles

¹ product will be discontinued as inventory is depleted

schedule 40

Size	Plated Carbon Steel		Stainless Steel	
	Part #	Price/E	Part #	Price/E
1½"	LP21	\$60.00	---	---
2"	LP26	53.20	---	---
3"	LP36	125.00	RLP36 ¹	\$221.40
4"	LP46	164.00	RLP46 ¹	375.00
6"	LP66	340.00	---	---



male NPT x hose shank

schedule 80²

Size	Plated Carbon Steel	
	Part #	Price/E
1½"	LP21-80	\$69.00
2"	LP26-80	71.85

¹ made from tubular steel

² schedule 80 stems meet NFPA 58

Clamps

Double Bolt Clamps

A rugged, plated iron two-bolt clamp with machine bolts and hex nuts.

- inner surface has dual gripping ridges
- bolt lugs are reinforced to prevent bending out of alignment



with saddles

Hose OD		Plated Iron		Opt Qty	Torque in ft. lbs.
from	to	Part #	Price/E		
3-32/64"	3-52/64"	400	\$19.65	25	40
3-50/64"	4-4/64"	431	23.50	20	40
4-2/64"	4-18/64"	463	21.10	20	40
4-16/64"	4-60/64"	525	26.05	10	60
4-32/64"	5-16/64"	550	27.15	10	60
5-8/64"	5-44/64"	600	29.60	10	60
5-44/64"	5-60/64"	639	33.00	10	60
5-60/64"	6-32/64"	675	31.55	10	60
6-32/64"	7-36/64"	769	35.30	10	60
7-44/64"	8-12/64"	818	51.00	5	125
8-16/64"	8-56/64"	875	50.75	5	125
8-60/64"	9-56/64"	988	62.15	5	125
9-60/64"	11-24/64"	1125	97.00	5	125
11-12/64"	13"	1275	107.55	3	125
12-12/64"	14"	1360	174.20	2	200
13-12/64"	15"	1450	163.60	2	200
15-4/64"	17-32/64"	1700	199.70	2	260

- measure hose OD accurately before ordering clamps
- Torque values for clamps are based on dry bolts. The use of lubricant on bolts will adversely effect clamp performance.
- Consult Dixon when using double bolt clamps on helical wire hose.

SAFETY ALERT

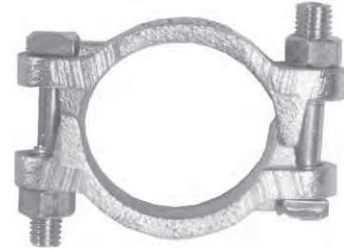

without saddles

Hose OD		Plated Iron		Opt Qty	Torque in ft. lbs.
from	to	Part #	Price/E		
1-8/64"	1-12/64"	J48	\$6.90	100	15
1-12/64"	1-24/64"	J49	8.70	50	21
1-28/64"	1-34/64"	JX49	11.40	25	21
1-40/64"	1-52/64"	DL14	12.90	25	40
1-48/64"	2-3/64"	DL20	12.70	25	27
2-7/64"	2-19/64"	DL24¹	12.70	25	27
2-20/64"	2-40/64"	DL32¹	13.70	25	40
2-32/64"	2-48/64"	DL275	16.90	25	40
2-48/64"	3-4/64"	DL306	19.10	20	60
3-4/64"	3-24/64"	DL328	20.30	20	60
3-16/64"	3-32/64"	DL350	19.65	20	60

¹ investment cast carbon steel

Single Bolt Clamps



- measure hose OD accurately before ordering clamps
- Torque values for clamps are based on dry bolts. The use of lubricant on bolts will adversely effect clamp performance.

SAFETY ALERT

Hose OD		Plated Iron		Torque in ft. lbs.
from	to	Part #	Price/E	
5/64"	1"	2	\$18.00	6
62/64"	1-8/64"	3	19.40	6
1-4/64"	1-12/64"	4	19.40	6
1-10/64"	1-16/64"	5	19.40	6
1-16/64"	1-24/64"	6	19.40	6
1-22/64"	1-28/64"	7	21.00	6
1-28/64"	1-36/64"	8	23.50	6
1-34/64"	1-44/64"	9	21.50	6
1-42/64"	1-48/64"	10	21.00	6
1-48/64"	1-56/64"	11	23.00	6
1-56/64"	2-2/64"	12	22.15	6
2"	2-8/64"	13	23.60	12
2-8/64"	2-18/64"	14	24.90	12
2-16/64"	2-26/64"	15	28.00	12

Hose OD		Plated Iron		Torque in ft. lbs.
from	to	Part #	Price/E	
2-24/64"	2-32/64"	16	\$23.60	12
2-32/64"	2-40/64"	17	23.60	12
2-40/64"	2-56/64"	18	27.25	12
2-56/64"	3-4/64"	19	26.45	12
3-4/64"	3-16/64"	20	25.90	12
3-16/64"	3-28/64"	21	29.25	12
3-28/64"	3-40/64"	22	28.90	21
3-40/64"	3-52/64"	23	37.85	21
3-52/64"	4-8/64"	24	35.75	21
4-8/64"	4-20/64"	25	37.00	21
4-16/64"	4-32/64"	26	37.55	21
4-28/64"	4-40/64"	27	43.40	21
4-40/64"	4-56/64"	X27	40.00	21
4-56/64"	5-16/64"	28	42.40	21

Crowder Supply Co., Inc. • 8495 Roslyn St., Commerce City, CO 80022 • Toll Free: 888-883-5144 • www.CrowderSupply.com

Spring Hose Clamps

- Single wire clamps have the most effective holding force and clamping strength. The single wire concentrates the clamping force in one specific area around the hose.
- Safety glasses should be worn when installing parts. **SAFETY ALERT**
- sold in box quantity only

Size	Hose OD		Carbon Steel		Pkg Qty
	from	to	Part #	Price/E	
5/16"	.309"	.315"	SHC0312	\$0.20	100
3/8"	.370"	.380"	SHC0375	0.22	100
1/2"	.490"	.510"	SHC0500	0.26	100
9/16"	.551"	.573"	SHC0562	0.32	100
5/8"	.610"	.640"	SHC0625	0.32	100
3/4"	.730"	.770"	SHC0750	0.35	100
13/16"	.792"	.832"	SHC0812	0.36	100
1"	.969"	1.031"	SHC1000	0.45	100
1-1/8"	1.100"	1.150"	SHC1125	0.59	50
1-1/4"	1.219"	1.280"	SHC1250	0.67	50
1-1/2"	1.469"	1.531"	SHC1500	1.25	50
1-5/8"	1.578"	1.672"	SHC1625	1.54	50



Spring Hose Clamp Pliers

Install single wire spring hose clamps quickly and easily using this simple hand tool.

- rugged construction
- easy to use, designed for efficiency

Part #	Price/E
SHCP	\$138.30



Spiral Clamps

For use on convoluted cover hose. To determine which style clamp is needed for your hose look at the end of the hose; if the helix spirals in a clockwise direction away from you (along the hose), a clockwise clamp is needed. If the helix spirals in a counterclockwise direction away from you, a counterclockwise clamp is needed. Examples include, but are not limited to: Kuriyama convoluted hose uses counter clockwise clamps; Pacific Echo and Kana Flex use clockwise clamps; Goodyear uses both counter clockwise and clockwise. More than one clamp may be needed per size, contact the hose manufacturer for more information.

- due to fluctuations in the OD of hose each individual installation should be checked **SAFETY ALERT**

Hose ID	Hose OD		Plated Steel, Right Hand		Plated Steel, Left Hand	
	from	to	Part #	Price/E	Part #	Price/E
1½"	1-34/64"	1-52/64"	SC150	\$12.50	SCCW150	\$12.50
2"	2-18/64"	2-32/64"	SC200	15.65	SCCW200	15.65
2½"	2-46/64"	3-8/64"	SC250	17.90	SCCW250	17.90
3"	3"	3-32/64"	SC300	19.40	SCCW300	19.40
4"	4"	4-32/64"	SC400	22.70	SCCW400	22.70
5"	5-6/64"	5-32/64"	SC500	29.35	SCCW500	29.35
6"	6-16/64"	7"	SC600	31.20	SCCW600	31.20
8"	8-32/64"	9-16/64"	SC800	37.60	SCCW800	37.60
10"	10-40/64"	11-16/64"	SC1000	46.65	SCCW1000	46.65



clockwise wound right hand spiral



counter clockwise wound left hand spiral

Clamps

T-Bolt Clamps



- T-bolts can be applied with a standard 7/16" socket wrench
- 3/4" wide 300 series stainless steel band, .025" thick
- alloy steel bolt, torque rating 70 in/lbs

- T-bolts can be applied with a standard 7/16" socket wrench
- 3/4" wide 300 series stainless steel band, .025" thick
- 300 series stainless steel bolt, torque rating 50 in/lbs

style TBC

Hose OD		Part #	Price/E	Opt Qty
from	to			
1.250"	1.406"	TBC131	\$9.30	25
1.344"	1.562"	TBC150	6.85	25
1.594"	1.812"	TBC175	6.85	25
1.724"	1.942"	TBC188	6.85	25
1.844"	2.062"	TBC200	6.85	25
2.094"	2.312"	TBC225	6.85	25
2.224"	2.442"	TBC238	6.85	25
2.344"	2.562"	TBC250	7.00	25
2.326"	2.622"	TBC256	6.75	25
2.396"	2.692"	TBC263	6.75	25
2.516"	2.812"	TBC275	6.75	25
2.646"	2.942"	TBC288	6.80	25
2.766"	3.062"	TBC300	6.80	25
2.886"	3.182"	TBC312	6.85	25
3.016"	3.312"	TBC325	6.85	25
3.266"	3.562"	TBC350	7.15	25
3.516"	3.812"	TBC375	7.15	25
3.586"	3.882"	TBC382	7.25	25
3.766"	4.062"	TBC400	7.25	25
4.016"	4.312"	TBC425	7.25	25
4.266"	4.562"	TBC450	7.25	25
4.516"	4.812"	TBC475	7.25	25
4.766"	5.062"	TBC500	7.30	25
5.016"	5.312"	TBC525	7.30	25
5.266"	5.562"	TBC550	7.80	25
5.516"	5.812"	TBC575	7.80	25
5.766"	6.062"	TBC600	7.85	25
6.016"	6.312"	TBC625	7.85	25
6.266"	6.562"	TBC650	7.90	25
6.516"	6.812"	TBC675	7.90	25
6.766"	7.062"	TBC700	8.05	25
7.266"	7.562"	TBC750	8.10	25

style STBC

Hose OD		Part #	Price/E	Opt Qty
from	to			
1.250"	1.4063"	STBC131	\$12.50	25
1.344"	1.562"	STBC150	7.90	25
1.474"	1.692"	STBC163	7.90	25
1.594"	1.812"	STBC175	7.90	25
1.724"	1.942"	STBC188	7.90	25
1.844"	2.062"	STBC200	7.90	25
1.964"	2.182"	STBC212	8.00	25
2.094"	2.312"	STBC225	8.00	25
2.224"	2.442"	STBC238	8.00	25
2.344"	2.562"	STBC250	8.05	25
2.326"	2.622"	STBC256	7.70	25
2.396"	2.692"	STBC263	7.70	25
2.516"	2.812"	STBC275	7.70	25
2.646"	2.942"	STBC288	7.75	25
2.766"	3.062"	STBC300	7.80	25
2.886"	3.182"	STBC312	7.80	25
3.016"	3.312"	STBC325	7.80	25
3.266"	3.562"	STBC350	8.05	25
3.516"	3.812"	STBC362	8.10	25
3.586"	3.882"	STBC375	8.10	25
3.766"	3.882"	STBC382	8.10	25
4.016"	4.062"	STBC400	8.10	25
4.016"	4.312"	STBC425	8.15	25
4.266"	4.562"	STBC450	8.15	25
4.516"	4.812"	STBC475	8.75	25
4.766"	5.062"	STBC500	8.90	25
5.016"	5.312"	STBC525	8.90	25
5.266"	5.562"	STBC550	9.35	25
5.516"	5.812"	STBC575	9.35	25
5.766"	6.062"	STBC600	9.50	25
6.016"	6.312"	STBC625	9.50	25
6.266"	6.562"	STBC650	9.50	25
6.516"	6.812"	STBC675	9.50	25
6.766"	7.062"	STBC700	9.75	25
7.016"	7.312"	STBC725	9.85	25
7.266"	7.562"	STBC750	9.85	25
7.766"	8.062"	STBC800	10.10	25
8.016"	8.312"	STBC825	10.10	25
8.266"	8.562"	STBC850	10.10	25
8.646"	8.942"	STBC888	10.75	25
8.766"	9.062"	STBC900	10.75	25
9.266"	9.562"	STBC950	10.75	25
9.766"	10.062"	STBC1000	10.70	10
10.646"	10.942"	STBC1088	11.60	10
11.766"	12.062"	STBC1200	11.60	10
12.646"	12.942"	STBC1288	11.60	10

Crowder Supply Co., Inc. • 8495 Roslyn St., Commerce City, CO 80022 • Toll Free: 888-883-5144 • www.CrowderSupply.com

Clamps

Clamps

Heavy Duty T-Bolt Clamps

- T-bolts can be applied with a standard 1/2" socket wrench.
- 7/8" wide 300 series stainless steel band, .040" thick
- 300 series stainless steel bolt, torque rating is 180 in/lbs



style HSTBC

Hose OD		Part #	Price/E
from	to		
2.125"	2.4375"	HSTBC238	\$14.60
2.250"	2.5625"	HSTBC250	14.70
2.750"	3.0625"	HSTBC300	14.90
3.250"	3.5625"	HSTBC350	15.20
3.750"	4.0625"	HSTBC400	15.40
4.250"	4.5625"	HSTBC450	15.60
4.750"	5.0625"	HSTBC500	15.90
5.250"	5.5625"	HSTBC550	16.10
5.750"	6.0625"	HSTBC600	16.30
6.250"	6.5625"	HSTBC650	16.60
6.750"	7.0625"	HSTBC700	16.80
7.250"	7.5625"	HSTBC750	17.10
7.750"	8.0625"	HSTBC800	17.30
8.266"	8.562"	HSTBC850	24.25
8.646"	8.942"	HSTBC888	24.75
8.766"	9.062"	HSTBC900	25.00
9.266"	9.562"	HSTBC950	25.50
9.766"	10.062"	HSTBC1000	26.25
10.646"	10.942"	HSTBC1088	27.50
11.766"	12.062"	HSTBC1200	29.00
12.646"	12.942"	HSTBC1288	30.50

- T-bolts can be applied with a standard 1/2" socket wrench.
- 7/8" wide 300 series stainless steel band, .040" thick
- carbon steel bolt, torque rating is 240 in/lbs

style HTBC

Hose OD		Part #	Price/E
from	to		
2.125"	2.4375"	HTBC238	\$12.90
2.250"	2.5625"	HTBC250	13.00
2.750"	3.0625"	HTBC300	13.20
3.250"	3.5625"	HTBC350	13.40
3.750"	4.0625"	HTBC400	13.60
4.250"	4.5625"	HTBC450	13.90
4.750"	5.0625"	HTBC500	14.10
5.250"	5.5625"	HTBC550	14.30
5.750"	6.0625"	HTBC600	14.50
6.250"	6.5625"	HTBC650	14.75
6.750"	7.0625"	HTBC700	15.00
7.250"	7.5625"	HTBC750	15.20
7.750"	8.0625"	HTBC800	15.40

Clamps

Long Bolt T-Bolt Clamps

- T-bolts can be applied with a standard 7/16" socket wrench.
- 3/4" wide 300 series stainless steel band, .025" thick
- 300 series stainless steel bolt, torque rating is 50 in/lbs



style STBCL

Hose OD		Part #	Price/E	Opt Qty
from	to			
2.80"	3.37"	STBC325L	\$10.90	25
3.05"	3.62"	STBC350L	10.90	25
3.37"	3.94"	STBC382L	10.90	25
3.55"	4.12"	STBC400L	11.00	25
3.75"	4.32"	STBC420L	11.00	25
3.87"	4.44"	STBC432L	11.00	25
4.05"	4.62"	STBC450L	11.00	25
4.37"	4.94"	STBC482L	11.25	25
4.55"	5.12"	STBC500L	11.25	25
4.87"	5.44"	STBC532L	11.25	25
5.05"	5.62"	STBC550L	11.25	25
5.37"	5.94"	STBC582L	11.30	25
5.55"	6.12"	STBC600L	11.40	25
5.87"	6.44"	STBC632L	11.40	25
6.05"	6.62"	STBC650L	11.50	25
6.30"	6.87"	STBC675L	11.50	25
6.53"	7.10"	STBC698L	11.60	25
6.55"	7.12"	STBC700L	11.60	25

style STBCL

Hose OD		Part #	Price/E	Opt Qty
from	to			
6.62"	7.19"	STBC707L	\$11.60	25
8.05"	8.62"	STBC850L	12.40	25
8.30"	8.87"	STBC875L	12.50	25
8.43"	9.00"	STBC888L	12.90	25
8.62"	9.19"	STBC907L	13.00	25
10.25"	10.82"	STBC1070L	13.00	25
10.43"	11.00"	STBC1088L	13.00	25
10.62"	11.19"	STBC1107L	13.00	25
10.72"	11.29"	STBC1117L	14.10	25
12.20"	12.77"	STBC1265L	13.50	25
12.43"	13.00"	STBC1288L	13.50	25
12.75"	13.32"	STBC1320L	13.50	25
14.20"	14.77"	STBC1465L	13.60	25
14.43"	15.00"	STBC1488L	13.60	25
14.75"	15.32"	STBC1520L	13.80	25
16.20"	16.77"	STBC1665L	14.30	25
16.43"	17.00"	STBC1688L	14.30	25